

Data Sheet for Piston Seal K23

Technical Data

Seal Materials	Max. Operating Temp °C	Pressure MPa	Glide Speed m/s
APU + AR1+ ATL	100	50	0.5
AF2 + AR1+ ATL	100	50	0.5

Media: Mineral oil-based hydraulic fluids.

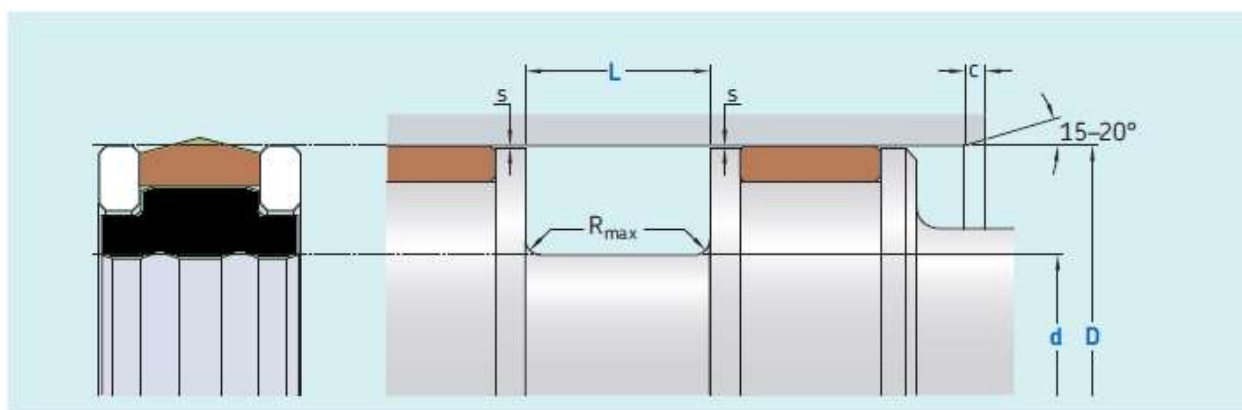

R_{max} : 0.3 mm

Standard dimensions				Max. radial extrusion clearance S (400 Bars)
Bore Dia range D mm	Groove OD d mm	Groove Length L mm	Total Length L ₁ mm	
20-50	D-10	12.5	20.5	0.35
50-80	D-15	20	28	0.50
80-150	D-20	25	36	0.65
150-400	D-25	32	46	0.80
400-600	D-30	36	50	1.00

Note: For temp above 70°C extrusion clearance have to be lower

Ordering example: Piston Seal K23 90 x 110x 25/ AR1+ATL + AF2